

DEF

Dynamic Exhaust Fan

The DEF dynamic exhaust fan is a variable speed exhaust fan that is ETL listed for Laundry Exhaust Systems, and High-Rise Exhaust Systems for laundry, bathroom and kitchen exhaust as well as Supply Air Systems. The DEF is suitable for indoor or outdoor use. The DEF provides negative pressure in the exhaust shaft or exhaust system, upstream of the venter, to ensure safe and efficient appliance operation. The DEF has a removeable clean-out door for easy maintenance. A variable speed direct drive motor provides quiet, efficient and maintenance free operation.

FEATURES

Applications - Laundry Exhaust System (LES)
High-Rise Exhaust System (HRS)
Supply Air System (SAS)

Performance - Maximum capacity up to 6,000 CFM
and up to 5" w.c. of static pressure

Construction - The housing is constructed of G90
galvanized steel and the dynamically balanced
backward inclined (BI) or curved (BC) impeller and
inlet ring is constructed in 5052 Aluminum

Motor - Electronically commutated 120VAC, 1ph
totally enclosed fan cooled

Inverter Duty 208, 480 or 575VAC 3ph, NEMA
premium induction, totally enclosed fan cooled

Listings and Ratings - UL 378, Standard for Draft
Equipment, CSA C22.2 No 133 CAN/CSA B255,
Addition to Rev 1996, UL 705, Standard for Safety
Power Ventilators; CSA C22.2, Fans and Ventilators

Warranty - Two year mechanical warranty

Made in America

ORDER MATRIX

DEF

Model:
004 - 050

Voltage:
1 = 120V/1ph
2 = 208V/3ph
4 = 480V/3ph
5 = 575V/3ph

STANDARD EQUIPMENT

Integrated clean-out access panel

Three foot flexible conduit

Motor isolation plate



Dimension Information						
Model	DEF004	DEF008	DEF015	DEF025	DEF035	DEF050
A	18-3/4"	21-1/2"	26-3/4"	29-1/4"	37-3/4"	40"
B	18-1/2"	21"	26"	28-1/2"	36-1/2"	38-1/2"
C	11-5/16"	12-1/2"	15-1/16"	16-5/16"	21-5/16"	22-5/16"
V	7-7/8"	9-7/8"	11-7/8"	15-7/8"	17-7/8"	19-7/8"
V1	8"	9"	11-1/4"	12-1/4"	16"	16-3/4"
V2	9-1/4"	10-1/2"	13"	14-1/4"	18-1/4"	19-1/4"
E	6-1/2"	7-3/8"	9-3/8"	9"	12-3/4"	13-1/4"
F	9-3/8"	10-3/4"	11-3/4"	12-5/8"	14-3/4"	15-1/4"
G	7-11/16"	7-5/16"	7-7/8"	8-1/4"	10-1/4"	10-1/2"
Weight	35 lbs	40 lbs	55 lbs	80 lbs	275 lbs	380 lbs
Voltage	120	120	120	120	208/480	208/480
Phase	1	1	1	1	3	3
Amps	6.25	6.25	6.25	12.9	9.8/4.9	12.6/6.4
HP	1/2	1/2	1/2	1	3	5
RPM	1950	1950	1950	1950	1740	1740
Impeller	BI	BI	BI	BI	BC	BC
Motor	EC	EC	EC	EC	ID	ID

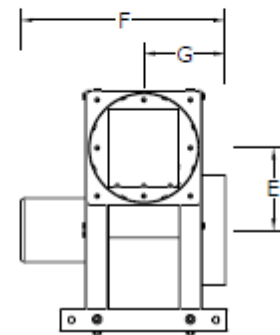
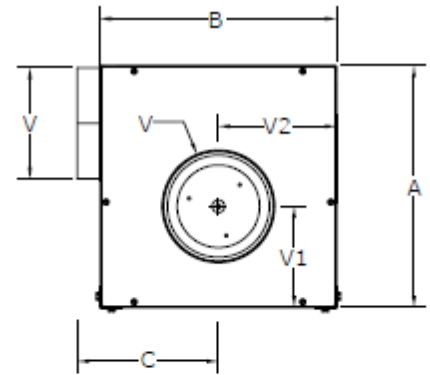

Capacity (1PH)				
SP	DEF004	DEF008	DEF015	DEF025
0	540	970	1,860	2,480
0.25	490	890	1,780	2,400
0.50	430	840	1,700	2,320
0.75	350	780	1,610	2,230
1.00	240	680	1,520	2,140
1.25	—	540	1,410	2,040
1.50	—	440	1,280	1,930
1.75	—	270	1,140	1,790
2.00	—	—	990	1,630

Capacity (3PH)		
SP	MEF035	MEF050
0	4,100	5,850
0.50	3,940	5,660
1.00	3,770	5,450
1.50	3,610	5,300
2.00	3,460	5,090
2.50	3,300	4,890
3.00	3,120	4,680
3.50	2,900	4,460
4.00	2,630	4,230

©2022, LFSsystems, All information subject to change without notice.
 Visit www.lfsystems.net for the most current information



100 S Sylvania Ave
 Fort Worth, TX 76111
 817-393-4029

Follow us on all platforms

