

Die Cast Aluminum

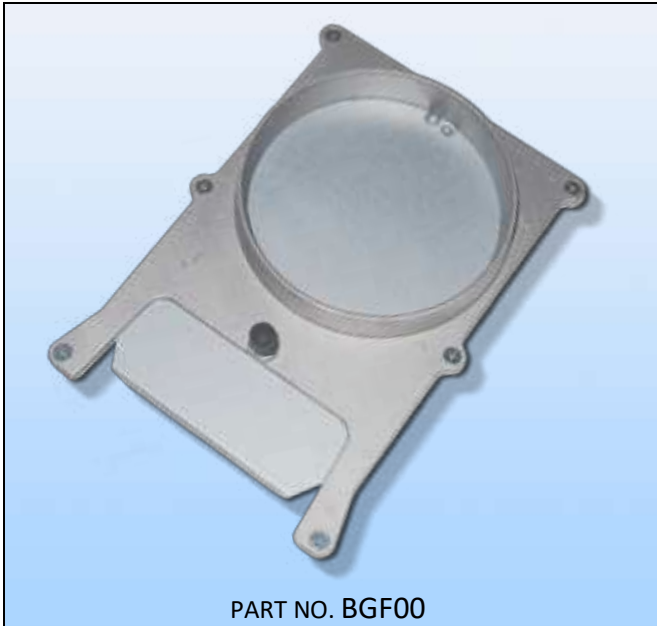

Die Cast Aluminum Full Blast Gate

- Used for wood, plastic, powder and other dusts in collector systems
- Economically designed. Locking screw included
- Connecting collars are undersized to allow slip-fit into nominal pipe or duct
- Bolt-together construction for ease of disassembly for cleaning
- Maximum temperature 400° F
- Available in sizes 2" to 30"

DIE CAST ALUMINUM FULL BLAST GATE

| DIA | PART # | A O.D. | B | C | D | E | F | WT. | |
|-----|--------|-----------|-------|-------|-------|------|------|------|--|
| 2" | BGF02 | 2.32 | 3.63 | 4.50 | 5.88 | 0.75 | 1.94 | 0.4 | |
| 3" | BGF03 | 2.82 | 4.01 | 5.64 | 7.00 | 0.75 | 1.91 | 0.7 | |
| 4" | BGF04 | 3.87 | 5.00 | 6.86 | 9.12 | 0.75 | 1.87 | 1.0 | |
| 5" | BGF05 | 4.76 | 6.00 | 8.00 | 11.75 | 0.88 | 2.16 | 1.4 | |
| 6" | BGF06 | 5.82 | 7.00 | 9.99 | 14.38 | 0.88 | 2.13 | 2.0 | |
| 7" | BGF07 | 6.81 | 8.00 | 11.25 | 15.62 | 1.05 | 2.50 | 2.7 | |
| 8" | BGF08 | 7.85 | 9.62 | 12.62 | 18.12 | 1.53 | 3.50 | 4.4 | |
| 9" | BGF09 | 8.88 | 10.62 | 13.60 | 20.38 | 1.33 | 3.17 | 5.4 | |
| 10" | BGF10 | 9.83 | 11.37 | 14.37 | 22.12 | 1.50 | 3.70 | 6.2 | |
| 11" | BGF11 | 10.88 | 12.37 | 15.37 | 25.38 | 1.44 | 3.44 | 7.4 | |
| 12" | BGF12 | 11.80 | 13.25 | 16.25 | 26.75 | 1.49 | 3.66 | 8.0 | |
| 14" | BGF14 | 13.84 | 15.79 | 18.96 | 30.12 | 1.88 | 4.39 | 11.8 | |
| 16" | BGF16 | 15.88 | 17.90 | 21.28 | 34.88 | 1.84 | 4.40 | 15.1 | |
| 18" | BGF18 | 17.80 | 20.23 | 32.81 | 40.38 | 3.11 | 7.04 | 30.0 | |
| 20" | BGF20 | 19.78 | 22.37 | 34.24 | 45.00 | 3.16 | 7.22 | 37.0 | |
| 22" | BGF22 | 21.72 | 24.60 | 34.11 | 47.25 | 3.12 | 7.10 | 45.0 | |
| 24" | BGF24 | 23.68 | 26.64 | 34.38 | 51.88 | 3.15 | 7.22 | 55.0 | |
| 26" | BGF26 | 25.75 | 28.56 | 36.75 | 57.90 | 3.02 | 7.10 | 59.5 | |
| 28" | BGF28 | 27.56 | 31.00 | 39.75 | 65.21 | 3.18 | 7.20 | 70.5 | |
| 30" | BGF30 | 29.56 | 33.19 | 42.50 | 66.74 | 3.06 | 7.15 | 77.2 | |

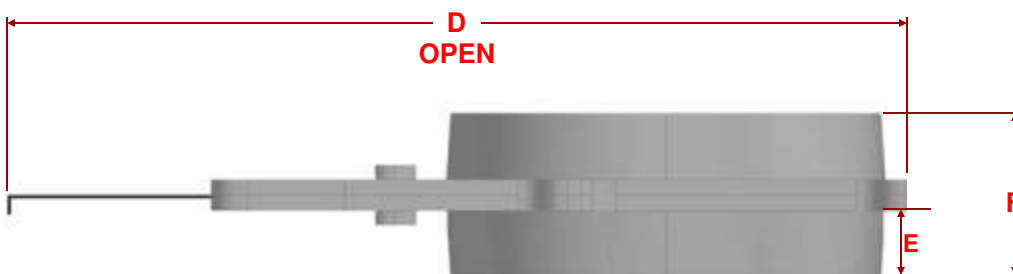

Hose to Gate Connector



- Used to provide an extended external lip for hose connection to a blast gate or ball joint. Slip hose over tapered end

| DIA | PART # | |
|------|--------|--|
| 2.5" | HGC2.5 | |
| 3" | HGC03 | |
| 4" | HGC04 | |
| 5" | HGC05 | |
| 6" | HGC06 | |
| 7" | HGC07 | |
| 8" | HGC08 | |
| 10" | HGC10 | |
| 12" | HGC12 | |

