

# Roof Downblast Exhaust Size-180: GB • G

Previously Size- G-183

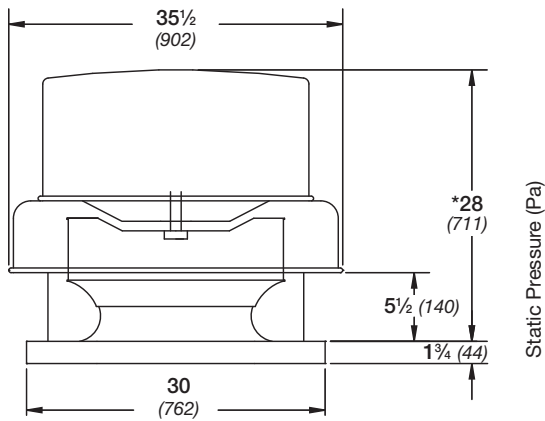

Damper Size = 18 x 18 (457 x 457)  
 Roof Opening = 20 1/2 x 20 1/2 (521 x 521)  
 Shroud Thickness = 0.064 (1.6)  
 Motor Cover Thickness = 0.040 (1.0)  
 Curb Cap Thickness = 0.064 (1.6)  
 ^Approximate Unit Weight G/GB = 108/142 lbs. (49/64 kg)  
 All dimensions in inches (millimeters). \*May be greater depending on motor. ^Weight shown is largest cataloged Open Drip-Proof motor.

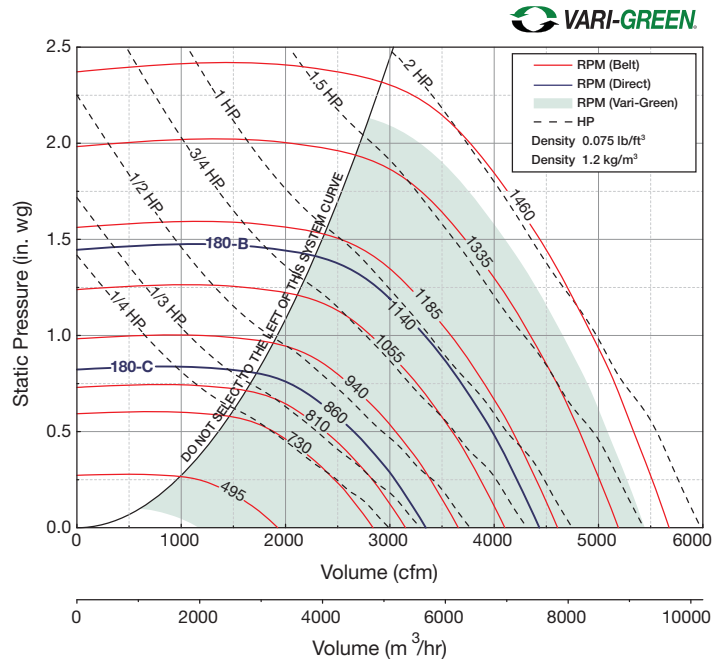

Direct Drive RPM	C-860 RPM	B-1140 RPM
------------------	-----------	------------

Motor HP	Fan RPM		Static Pressure in Inches wg										
	Belt	Direct	0	0.125	0.25	0.5	0.75	1	1.25	1.5	1.75	2	
<b>180</b>													
1/4	VG-1	730	CFM	2839	2668	2469	1882						
			BHP	0.21	0.23	0.25	0.25						
1/3	VG-1	810	CFM	3150	2997	2832	2375						
			BHP	0.29	0.31	0.33	0.35						
1/2	C-1/2	860	CFM	3344	3202	3049	2647	2015					
			BHP	0.35	0.36	0.39	0.42	0.4					
3/4	C-1/2	940	CFM	3655	3527	3388	3052	2601					
			BHP	0.46	0.47	0.49	0.54	0.54					
1	VG-2	1140	CFM	3888	3769	3638	3339	2953	2387				
			BHP	0.55	0.57	0.58	0.64	0.66	0.63				
1 1/2	VG-2	1335	CFM	4102	3990	3867	3596	3252	2811				
			BHP	0.65	0.67	0.68	0.74	0.77	0.77				
2	VG-2	1400	CFM	4433	4329	4216	3980	3684	3328	2856			
			BHP	0.81	0.84	0.85	0.93	0.96	0.98	0.95			
2	VG-2	1460	CFM	4608	4508	4401	4179	3900	3575	3178	2499		
			BHP	0.91	0.94	0.96	1.03	1.07	1.1	1.09	0.99		
2	VG-2	1460	CFM	5191	5102	5010	4814	4599	4344	4052	3713	3262	
			BHP	1.31	1.33	1.36	1.41	1.49	1.54	1.57	1.56	1.51	
2	VG-2	1460	CFM	5444	5359	5273	5086	4892	4655	4401	4097	3747	3253
			BHP	1.51	1.54	1.56	1.61	1.71	1.75	1.81	1.81	1.79	1.71
2	VG-2	1460	CFM	5677	5596	5514	5336	5155	4938	4699	4426	4123	3765
			BHP	1.71	1.74	1.77	1.81	1.93	1.97	2.03	2.05	2.05	2.02
2	VG-2	1460	Sones	24	23	23	22	22	21	21	20	19.7	19.2
			Sones	26	25	24	24	23	23	22	22	22	22

Performance certified is for installation type A: Free inlet, Free outlet. Power rating (BHP) does not include transmission losses. Performance ratings include the effects of a birdscreen. The sound ratings shown are loudness values in hemispherical sones at 5 ft. (1.5 m) in a hemispherical free field calculated per AMCA Standard 301. Values shown are for installation type A: free inlet hemispherical sone levels.