

Roof Downblast Exhaust Size-300: GB • G

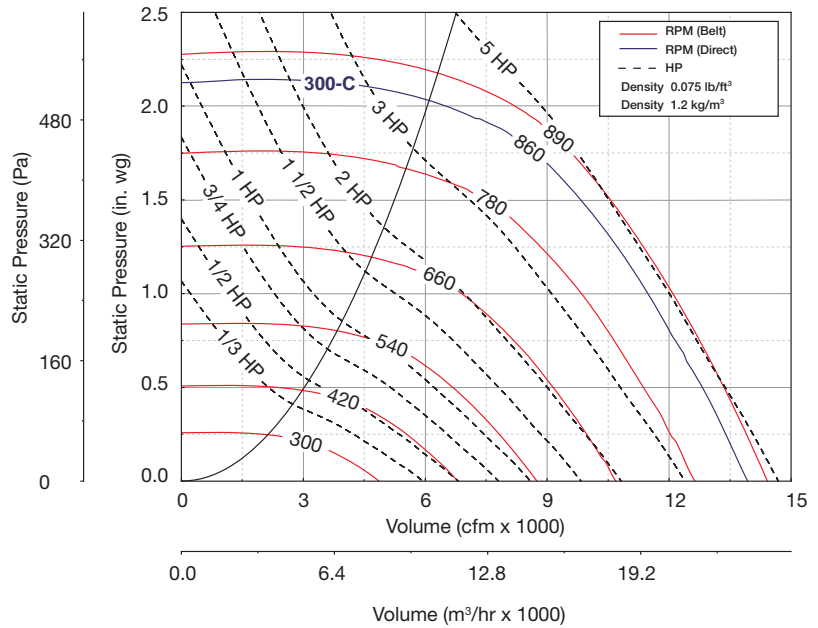
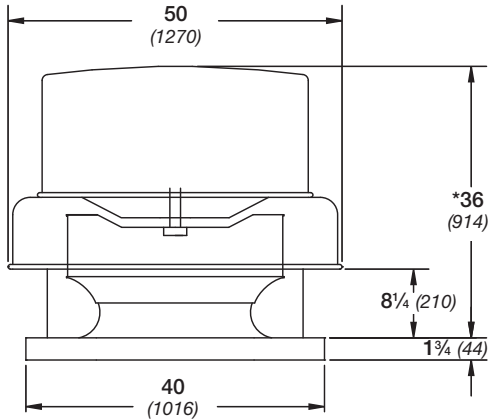

Damper Size = 30 x 30 (762 x 762)
 Roof Opening = 32½ x 32½ (826 x 826)
 Shroud Thickness = 0.064 (1.6)
 Motor Cover Thickness = 0.051 (1.3)
 Curb Cap Thickness = 0.064 (1.6)
 ^Approximate Unit Weight = 320 lbs. (145 kg)

All dimensions in inches (millimeters). *May be greater depending on motor. ^Weight shown is largest cataloged Open Drip-Proof motor.

Direct Drive RPM
 C-860 RPM

Motor HP		Fan RPM	Static Pressure in Inches wg										
Belt	Direct		0	0.125	0.25	0.5	0.75	1	1.25	1.5	1.75	2	
300													
1/3		300	CFM	4859	3976								
			BHP	0.18	0.19								
			Sones	9.3	5.3								
1/2		420	CFM	6803	6222	5537							
			BHP	0.50	0.52	0.53							
			Sones	9.6	8.0	7.0							
3/4		475	CFM	7694	7197	6616	5095						
			BHP	0.72	0.75	0.77	0.74						
			Sones	11.4	10.6	9.6	8.1						
1		530	CFM	8585	8150	7640	6456	4195					
			BHP	1.00	1.04	1.06	1.07	0.91					
			Sones	13.4	12.9	12.2	10.7	9.4					
1½		600	CFM	9719	9334	8907	7952	6721					
			BHP	1.45	1.49	1.53	1.55	1.52					
			Sones	15.9	15.4	14.9	13.8	12.2					
2		665	CFM	10772	10425	10060	9228	8269	7025				
			BHP	1.97	2.02	2.06	2.11	2.11	2.03				
			Sones	18.8	18.2	17.7	16.8	15.7	13.7				
3		713	CFM	11549	11226	10901	10129	9297	8283	6691			
			BHP	2.43	2.48	2.53	2.59	2.61	2.57	2.38			
			Sones	21	20	19.6	18.9	18.0	16.4	13.7			
	C-5	860	CFM	12311	12007	11704	10997	10242	9369	8293	6437		
			BHP	2.94	3.00	3.05	3.13	3.16	3.15	3.06	2.76		
			Sones	23	22	21	21	19.8	18.6	16.8	14.0		
5		825	CFM	13363	13084	12804	12175	11501	10770	9909	8885	7128	
			BHP	3.76	3.82	3.88	3.97	4.02	4.05	4.01	3.90	3.56	
			Sones	25	25	24	24	23	22	20	18.7	16.1	
5		890	CFM	13930	13662	13394	12801	12158	11475	10709	9804	8599	6464
			BHP	4.26	4.32	4.38	4.49	4.55	4.58	4.57	4.49	4.29	3.77
			Sones	27	27	27	25	25	24	23	21	19.9	17.7
5		890	CFM	14416	14157	13898	13335	12716	12073	11379	10536	9568	7963
			BHP	4.73	4.79	4.85	4.96	5.03	5.06	5.09	5.02	4.89	4.54
			Sones	28	28	28	27	26	25	24	22	21	18.7

MAXIMUM BHP AT A GIVEN RPM = (RPM/517)³
 MAXIMUM RPM = 890
 TIP SPEED (ft/min) = RPM x 7.985
 MAXIMUM MOTOR FRAME SIZE = 184T

Performance certified is for installation type A: Free inlet, Free outlet. Power rating (BHP) does not include transmission losses. Performance ratings include the effects of a birdscreen. The sound ratings shown are loudness values in hemispherical sones at 5 ft. (1.5 m) in a hemispherical free field calculated per AMCA Standard 301. Values shown are for installation type A: free inlet hemispherical sone levels.